

Vacuum Filtration System



Features

- **No air pollution, maintenance free**
Rocker series pumps are piston-driven, no need of lubricant, regular oil changes and maintenance; with no oil pollution.
- **The patented spin-lock design**
Rocker 300 - LF 30 filter holder can be connected with waste bottle by patented spin-lock connection (M381450) giving a fast and stable installation without clamp.
- **The patented magnetic design**
Rocker 300 - MF 31 strong magnetic seal (I551337) allows one-handed operation, prevents possible twisting and tearing of the membrane.
- **Overflow protection**
Rocker 300 - LF 30 waste bottle comes with a built-in overflow protection to keep the filtrate from overflowing when waste bottle is full.
- **International certification**
CE certification
CSA certification
IP30 protection
RoHS certification

Two-Year Warranty

Applications

- Suspended solid test
- Vacuum filtration

Ordering Information

167305-11(22)

Rocker 300 - LF 30, Vacuum Filtration System, complete set includes :

- * Rocker 300, Vacuum Pump
- * LF 30, Filtration Set
- * Silicone Tube (1m)

167311-11(22)

Rocker 300 - MF 31, Vacuum Filtration System, complete set includes :

- * Rocker 300, Vacuum Pump
- * MF 31, Filtration Set
- * Silicone Tube (1m)



Specification

Model	Rocker 300 - LF 30		Rocker 300 - MF 31	
Voltage / Freq.	110V/60Hz	220V/50Hz	110V/60Hz	220V/50Hz
Max. flow rate	23 L/min	20 L/min	23 L/min	20 L/min
Max. vacuum	105 mbar / 91 kPa / 26.8 inHg		105 mbar / 91 kPa / 26.8 inHg	
Capacity (Funnel / Waste bottle)	300 ml / 1200 ml		300 ml / 1000 ml	
Filter diameter	47 mm		47 mm	
Effective filtration area	12.5 cm ²		13.1 cm ²	
Hose barb	5/16 inch (8 mm)		5/16 inch (8 mm)	
Part	Material		Material	
Filter funnel	PES		PES	
Funnel support base	PC		PES	
Membrane support	PP		PES	
Waste bottle	PC		Borosilicate glass	
Funnel lid	PP		PP	
Overflow protection	PP		-	

Vacuum Filtration System

Features

- **No air pollution, maintenance free**
Rocker 300C vacuum pump is driven by diaphragm, no need of lubricant, regular oil changes and maintenance; with no oil pollution.
- **Good chemical resistance**
Rocker 300C / Chemker 300 / Lafil 300C -VF12 systems all can offer good resistance to a wide range of corrosive gases.
- **One-step filtration**
VF 12 can filtrate and store solution directly in GL45 storage bottle without transferring from the flask and hence preventing cross-contamination.
- **Suitable for all GL45 storage bottle**
Unique filtration adaptor design can connect with GL45 storage bottle (1000ml, 2000ml, 5000ml...etc.)
- **International certification**
CE certification
- **One-Year Warranty**

Applications

- Solvent purification
- HPLC mobile phase purification
- Vacuum filtration

Ordering Information

189302-11(22)

Rocker 300C - VF 12, Vacuum Filtration System, complete set includes :

- * Rocker 300C, Vacuum Pump
- * VF 12, Filtration Set
- * Silicone Tube (1m)

169302-11(22)

Chemker 300 - VF 12, Vacuum Filtration System, complete set includes :

- * Chemker 300, Vacuum Pump
- * VF 12, Filtration Set
- * Silicone Tube (1m)

197331-11(22)

Lafil 300C - VF 12, Vacuum Filtration System, complete set includes :

- * Lafil 300C, Vacuum Pump
- * VF 12, Filtration Set
- * Silicone Tube (1m)



Chemker 300 - VF 12

Lafil 300C - VF 12

Specification

Model	Rocker 300C - VF 12		Chemker 300 - VF 12		Lafil 300C - VF 12	
Voltage	110V/60Hz	220V/50Hz	110V/60Hz	220V/50Hz	110V/60Hz	220V/50Hz
Max. flow rate	23 L/min	20 L/min	20 L/min	18 L/min	23 L/min	20 L/min
Max. vacuum	170 mbar / 84 kPa / 24.8 inHg		105 mbar / 91 kPa / 26.8 inHg		170 mbar / 84 kPa / 24.8 inHg	
Capacity (Funnel / Waste bottle)	300 ml / 1000 ml		300 ml / 1000 ml		300 ml / 1000 ml	
Filter diameter	47 mm		47 mm		47 mm	
Effective filtration area	9.6 cm ²		9.6 cm ²		9.6 cm ²	
Hose barb	5/16 inch (8 mm)		5/16 inch (8 mm)		5/16 inch (8 mm)	
Part	Material		Material		Material	
Funnel	Borosilicate glass		Borosilicate glass		Borosilicate glass	
Membrane support	Sintered glass		Sintered glass		Sintered glass	
Clamp	Aluminum		Aluminum		Aluminum	
Filtration adaptor	PP		PP		PP	
Stopper	Silicone (No.8)		Silicone (No.8)		Silicone (No.8)	
Storage bottle	Borosilicate glass		Borosilicate glass		Borosilicate glass	

Vacuum Filtration System



Features

- Compact and safe operation**
 Lafil 300 is a unique filtration system by combining vacuum source with filtration ware. Its compact design can save much bench space than the traditional ones. With a fence-like platform design, it can prevent user's negligence from tipping over the waste bottle.
- The patented spin-lock design**
 The filter holder can be connected with waste bottle by patented spin-lock connection giving a fast and stable installation without clamp.
- Overflow protection**
 Waste bottle comes with a built-in overflow protection to keep the filtrate from overflowing when waste bottle is full.
- Autoclavable and shatterproof**
 Waste bottle and filter holder are made of engineering plastics and SS316 stainless steel which are shatterproof, high temperature resistance and autoclavable.



Lafil 300 - LF 30



Lafil 300 - LF 32

Specification

Model	Lafil 300 - LF 30		Lafil 300 - LF 32	
Voltage / Freq.	110V/60Hz	220V/50Hz	110V/60Hz	220V/50Hz
Max. power	65W	60W	65W	60W
Max. current	0.7A	0.3A	0.7A	0.3A
Max. vacuum	105 mbar / 91 kPa / 26.8 inHg		105 mbar / 91 kPa / 26.8 inHg	
Max. flow rate	23 L/min	20 L/min	23 L/min	20 L/min
Motor rotation speed	1750 RPM	1450 RPM	1750 RPM	1450 RPM
Hose barb	5/16 inch (8 mm)		5/16 inch (8 mm)	
Dimension (LxWxH)	33.5 x 23 x 45 cm		33.5 x 23 x 40 cm	
Part	Material		Material	
Funnel	PES		SS316	
Waste bottle	PC		PC	
Membrane support	PP		SS316	
Funnel lid	PP		—	
Overflow protection	PP		PP	

- International certification**
 CE certification
- Two-Year Warranty**

Applications

- Vacuum filtration
- Suspended solid test
- Microbiological test

Ordering Information

- 197301-11(22)**
 Lafil 300 - LF 30, Vacuum Filtration System, AC110V, 60Hz (AC220V, 50Hz)
- 197302-11(22)**
 Lafil 300 - LF 32, Vacuum Filtration System, AC110V, 60Hz (AC220V, 50Hz)
- 197300-11(22)**
 Lafil 300, Vacuum Pump AC110V, 60Hz (AC220V, 50Hz)

Vacuum Filtration System



Features

- Compact and safe operation**
 Lafil 400 series is a unique filtration system by combining vacuum source with filtration ware. Its compact design can save much bench space than the traditional ones. With a fence-like platform design, it can prevent user's negligence from tipping over the waste bottle.
- The patented spin-lock design**
 The filter holder can be connected with waste bottle by patented spin-lock connection giving a fast and stable installation without clamp.
- Overflow protection**
 Waste bottle comes with a built-in overflow protection to keep the filtrate from overflowing when waste bottle is full.
- Autoclavable and shatterproof**
 Waste bottle and filter holder are made of engineering plastics and SS316 stainless steel which are shatterproof, high temperature resistance and autoclavable.



Lafil 400 - LF 30



Lafil 400 - LF 32

Specification

Model	Lafil 400 - LF 30		Lafil 400 - LF 32	
Voltage / Freq.	110V/60Hz	220V/50Hz	110V/60Hz	220V/50Hz
Max. power	100W	80W	100W	80W
Max. current	1.0A	0.4A	1.0A	0.4A
Max. vacuum	30 mbar / 98 kPa / 28.9 inHg		30 mbar / 98 kPa / 28.9 inHg	
Max. flow rate	23 L/min	20 L/min	23 L/min	20 L/min
Motor rotation speed	1750 RPM	1450 RPM	1750 RPM	1450 RPM
Hose barb	5/16 inch (8 mm)		5/16 inch (8 mm)	
Dimension (LxWxH)	33.5 x 23 x 45 cm		33.5 x 23 x 40 cm	
Part	Material		Material	
Funnel	PES		SS316	
Waste bottle	PC		PC	
Membrane support	PP		SS316	
Funnel lid	PP		—	
Overflow protection	PP		PP	

- International certification**
 CE certification
- Two-Year Warranty**

Applications

- Vacuum filtration
- Suspended solid test
- Microbiological test

Ordering Information

- 197401-11(22)**
 Lafil 400 - LF 30, Vacuum Filtration System, AC110V, 60Hz (AC220V, 50Hz)
- 197402-11(22)**
 Lafil 400 - LF 32, Vacuum Filtration System, AC110V, 60Hz (AC220V, 50Hz)
- 197400-11(22)**
 Lafil 400, Vacuum Pump AC110V, 60Hz (AC220V, 50Hz)

Filtration Accessories



PES / PC Waste Bottles

Specification	1200 ml, PES waste bottle	1200 ml, PC waste bottle
Catalog number	197000-11	197000-11-PC
Graduated increment	100 ml	100 ml
Overflow protection	Yes	Yes
Cap with suction fitting	Yes	Yes
Hose barb	5/16 (8 mm)	5/16 (8 mm)
Autoclavable	Yes	Yes



GL45 Suction Cap / Filtration Adaptor

Specification	GL45 suction cap	GL45 filtration adaptor
Catalog number	197000-60	197000-65
Material of cap	PP	PP
Material of gasket	-	PTFE
Stopper	-	No. 8 stopper
Hose barb	1/4 inch (6 mm)	4 - 8 mm
Autoclavable	Yes	Yes



Membrane Filters

Specification	Glass fiber filter	MCE membrane
Catalog number	167100-20	167100-52
Brand	Pall	Pall
Filter diameter	47 mm	47 mm
Pore size	1µm	0.45µm
Material of filter	Glass fiber	MCE
Package	100/PK	200/PK



Silicone Fixing Sucker

Specification	Silicone fixing sucker
Catalog number	167200-45
Material	Silicone
Compatible receiver flask	1000 ml receiver flask
Autoclavable	Yes



* PES : Polyethersulfone, PC : Polycarbonate, PP : Polypropylene

Filtration Accessories

PP Heavy-Duty Vacuum Bottle

Specification	4000 ml, PP vacuum bottle	4000 ml, PP vacuum bottle with drain	4000 ml, PP vacuum bottle with quick-coupling connector
---------------	---------------------------	--------------------------------------	---



Catalog number	197200-47	197200-48	197200-53
Hose barb	1/4 inch hose barb	1/4 inch hose barb	1/4 inch quick-coupling connector
Graduated increment	500 ml	500 ml	500 ml
Overflow protection	Yes	Yes	Yes
Hose barb	1/4 inch (6 mm)	1/4 inch (6 mm)	1/4 inch (6 mm)
Drain device	-	Yes	-
Autoclavable	Yes	Yes	Yes

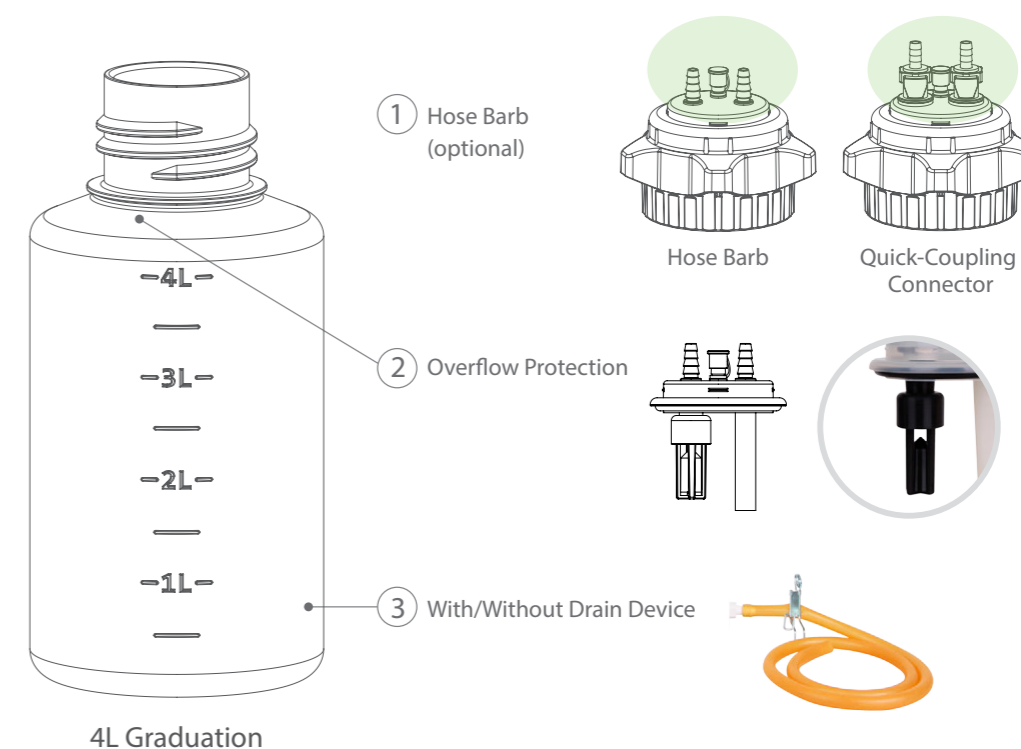

* PES : Polyethersulfone, PC : Polycarbonate, PP : Polypropylene

LABORATORY FILTRATION

Filtration Apparatus Selection Guide

Filter Holder

MF 3 / MF 3a / MF 5 / MF 5a

LF 3 / LF 3a / LF 5 / LF 5a

Stainless Steel Filter Holder

SF 1 / SF 3 / SF 5

SS 1 / SS 3 / SS 5

Filtration Apparatus

LF 30 / MF 31

VF 2 / VF 11

VF 5 / VF 8 / VF 6 / VF 7

VF 3 / VF 10 / VF 12 / VF 15

Filtration System

Rocker 300 - LF 30 / Rocker 300 - MF 31

Rocker 300C - VF 12 / Chemker300 - VF 12

Lafil 300C - VF 12

Lafil 300 - LF 30 / Lafil 300 - LF 32

Lafil 400 - LF 30 / Lafil 400 - LF 32

Manifold

MutilVac 310 - MS / MutilVac 610 - MS

MutilVac 300 - MS / MutilVac 600 - MS

MutilVac 300 - MB / MutilVac 600 - MB

MutilVac 301 - MB / MutilVac 601 - MB

MultiVac 310 - MS - A / MultiVac 610 - MS - A

MultiVac 301 - MB - A / MultiVac 601 - MB - A

MutilVac 310 - MS - T / MutilVac 610 - MS - T

MutilVac 301 - MB - T / MutilVac 601 - MB - T

Filtration System

WaterVac 100 - MS / WaterVac 100 - MB / WaterVac 101 - MB

WaterVac 200 - MS / WaterVac 200 - MB / WaterVac 201 - MB

Filtration Apparatus Selection Guide

PES	SS316 Stainless Steel	Borosilicate Glass	
 <p>LF 30 P.23</p>	 <p>VF 2 P.24</p>	 <p>VF 5 P.25</p>  <p>VF 8 P.25</p>	
 <p>MF 31 P.23</p>	 <p>VF 11 P.24</p>	 <p>VF 6 P.26</p>  <p>VF 7 P.26</p>	
MF, Magnetic Filter Holder		SF, Outer Spin-Lock Filter Holder	
 <p>MF 3 P.19</p>  <p>MF 3a P.19</p>	 <p>SF 1 P.21</p>  <p>SF 3 P.21</p>  <p>SF 5 P.21</p>	 <p>VF 3 P.27</p>  <p>VF 10 P.27</p>	
 <p>MF 5 P.19</p>  <p>MF 5a P.19</p>			
LF, Spin-Lock Filter Holder		SS, Inner Spin-Lock Filter Holder	
 <p>LF 3 P.20</p>  <p>LF 3a P.20</p>	 <p>SS 1 P.22</p>  <p>SS 3 P.22</p>  <p>SS 5 P.22</p>	 <p>VF 12 P.28</p>  <p>VF 15 P.28</p>	
 <p>LF 5 P.20</p>  <p>LF 5a P.20</p>			

*PES : Polyethersulfone

MF, Magnetic Filter Holder



Features

- ▶ Compatible with various kinds of bottle, vacuum flask with or without side arm to collect filtrate directly.
- ▶ Strong magnetic seal allows one-handed operation, prevents possible twisting and tearing of the membrane.
- ▶ Membrane guide on the base helps position membrane easily.
- ▶ PES (Polyethersulfone) construction, resistant to a wide range of chemicals and high temperature, sturdy and unbreakable.
- ▶ MF magnetic filter holder was awarded the United States (US 9.452.373B1), Taiwan (I551337) and China (ZL 2015 2 0050109.6) invention patent.
- ▶ International environmental declaration: RoHS certification

Specifications

Material	MF 3 / MF 5	MF 3a / MF 5a
Funnel	PES	PES
Support base	PES	PES
Membrane support	PES	PES
Funnel lid	PP	PP
Hose barb	PES	PES
Syringe filter	PTFE	PTFE

Specifications	MF 3 / MF 5	MF 3a / MF 5a
Funnel capacity	300 ml / 500 ml	300 ml / 500 ml
Filter diameter	47 mm	47 mm
Effective filtration area	13.1 cm ²	13.1 cm ²
Syringe filter	25 mm, 0.2 μm	25 mm, 0.2 μm
Hose barb	4-8 mm	4-8 mm

Ordering Information

MF 3, Magnetic Filter Holder (300 ml)	200300-01
MF 5, Magnetic Filter Holder (500 ml)	200500-01
1 PP lid kit	200300-36
2 PES magnetic funnel, 300 ml	200300-30
2 PES magnetic funnel, 500 ml	200500-30
3 PES magnetic support base	200300-32
4 Silicone stopper (No.8)	167110-16
MF 3a, Magnetic Filter Holder (300 ml)	200310-01
MF 5a, Magnetic Filter Holder (500 ml)	200510-01
1 PP lid kit	200300-36
2 PES magnetic funnel, 300 ml	200300-30
2 PES magnetic funnel, 500 ml	200500-30
3 PES magnetic support base (short)	200310-32

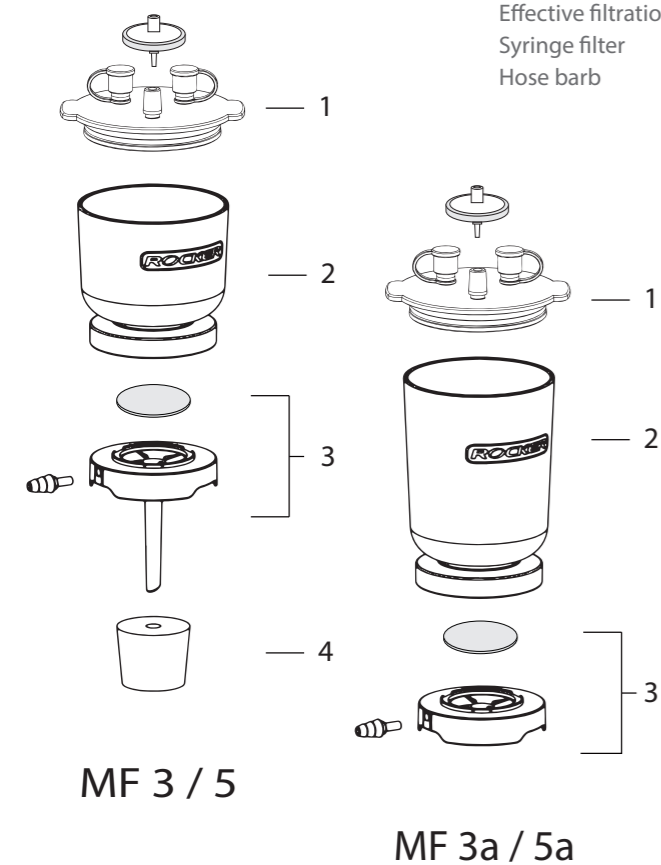

LF, Spin-Lock Filter Holder

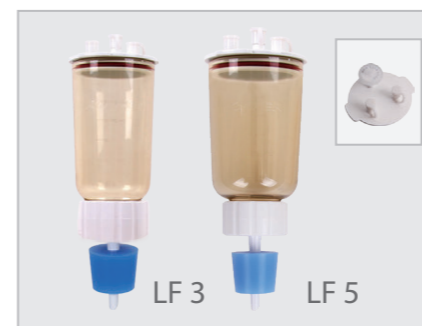

Features

- ▶ Spin-lock connection (M381450) facilitates fast and stable installation without clamp.
- ▶ PES structure offers excellent smash, high temperature (180°C) resistance and autoclavable.
- ▶ Groove design on membrane support facilitates filtration speed.
- ▶ Reusable, friendly to the earth and save your money.
- ▶ Funnel graduated in 50ml increments for easy measurement.
- ▶ LF 3 / 5 equips with No. 8 stopper that allows it to fit other receiver flasks.
- ▶ LF 3a / 5a is available to fit any GL45 laboratory glass bottle.

Specifications

Material	LF 3 / LF 5	LF 3a / LF 5a
Funnel	PES	PES
Support base	PC	PC
Membrane support	PP	PP
Funnel lid	PP	PP
Cap of lid	Silicone	Silicone
Syringe filter	PTFE	PTFE

Specifications

Funnel capacity	300 ml / 500 ml	300 ml / 500 ml
Filter diameter	47 mm	47 mm
Effective filtration area	12.5 cm ²	12.5 cm ²
Syringe filter	25 mm, 0.2 μm	25 mm, 0.2 μm
Lid inlet fitting diameter	7 mm	7 mm

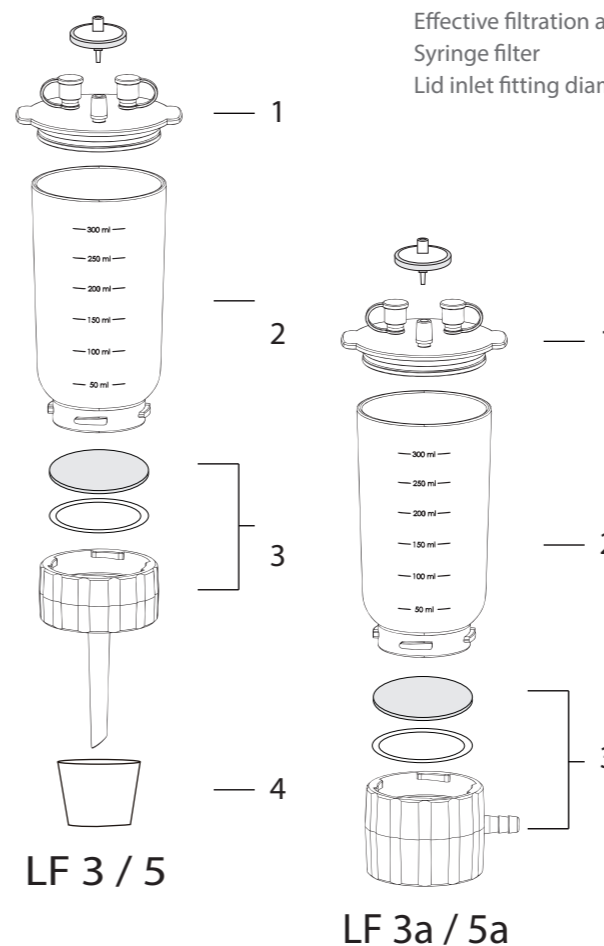

Ordering Information

LF 3, Spin-Lock Filter Holder (300 ml)	197000-01
LF 5, Spin-Lock Filter Holder (500 ml)	197000-06
1 LF 3, PP lid kit	197000-36
1 LF 5, PP lid kit	200300-36
2 PES funnel, 300 ml	197000-34
2 PES funnel, 500 ml	197000-56
3 PC support base	197000-35
4 Silicone stopper (No. 8)	167110-16
LF 3a, Spin-Lock Filter Holder (300 ml)	197000-02
LF 5a, Spin-Lock Filter Holder (500 ml)	197000-07
1 LF 3a, PP lid kit	197000-36
1 LF 5a, PP lid kit	200300-36
2 PES funnel, 300 ml	197000-34
2 PES funnel, 500 ml	197000-56
3 Storage bottle adaptor	197000-38

SF, Stainless Steel Filter Holder



Features

- New outer spin-lock connection facilitates fast and stable installation without clamp.
- Laser-marked graduation helps accurately sample addition.
- Forceps access points on support base help retrieve membrane easily.
- SS316 funnel offers excellent chemical resistance and can be fast sterilized by flame.

Specifications

Material	100 ml	300 ml	500 ml
Funnel	SS316	SS316	SS316
Support base	SS316	SS316	SS316
Membrane support	SS316	SS316	SS316
Funnel lid	SS316	SS316	SS316

Specifications

Funnel capacity	100 ml	300 ml	500 ml
Filter diameter	47 mm	47 mm	47 mm
Effective filtration area	11.6 cm ²	11.6 cm ²	11.6 cm ²
Support pore size	70 μm	70 μm	70 μm

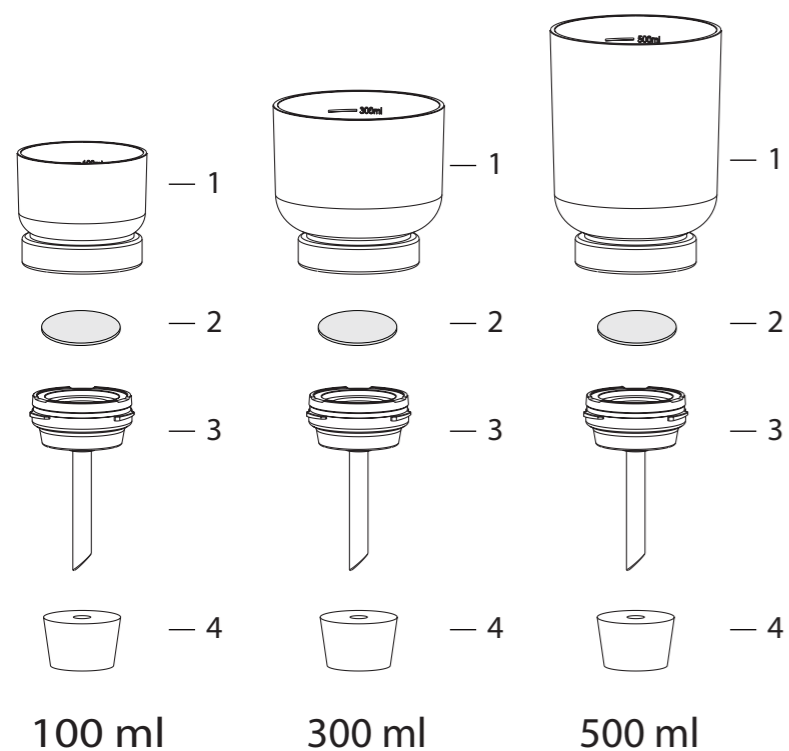

Ordering Information

SF 1, Stainless Steel Filter Holder (100 ml) 180100-10

- 1 Stainless steel funnel, 100 ml 180100-01
- 2 Stainless steel support screen 180100-31
- 3 Stainless steel support base 180100-00
- 4 Silicone stopper (No.8) 167110-16

SF 3, Stainless Steel Filter Holder (300 ml) 180100-30

- 1 Stainless steel funnel, 300 ml 180100-03
- 2 Stainless steel support screen 180100-31
- 3 Stainless steel support base 180100-00
- 4 Silicone stopper (No.8) 167110-16

SF 5, Stainless Steel Filter Holder (500 ml) 180100-50

- 1 Stainless steel funnel, 500 ml 180100-05
- 2 Stainless steel support screen 180100-31
- 3 Stainless steel support base 180100-00
- 4 Silicone stopper (No.8) 167110-16

SF, Stainless Steel Lid

- 100 ml Stainless steel lid 180100-11
- 300 ml / 500 ml Stainless steel lid 180100-13

SS, Stainless Steel Filter Holder



Features

- Inner spin-lock connection (M381450) facilitates fast and stable installation without clamp.
- Intuitive operation by 360° ring graduation mark.
- SS316 funnel offers excellent chemical resistance and can be fast sterilized by flame.

Specifications

Material	100 ml	300 ml	500 ml
Funnel	SS316	SS316	SS316
Support base	SS316	SS316	SS316
Membrane support	SS316	SS316	SS316
Funnel lid	SS316	SS316	SS316

Specifications

Funnel capacity	100 ml	300 ml	500 ml
Filter diameter	47 mm	47 mm	47 mm
Effective filtration area	9.6 cm ²	9.6 cm ²	9.6 cm ²
Support pore size	70 μm	70 μm	70 μm

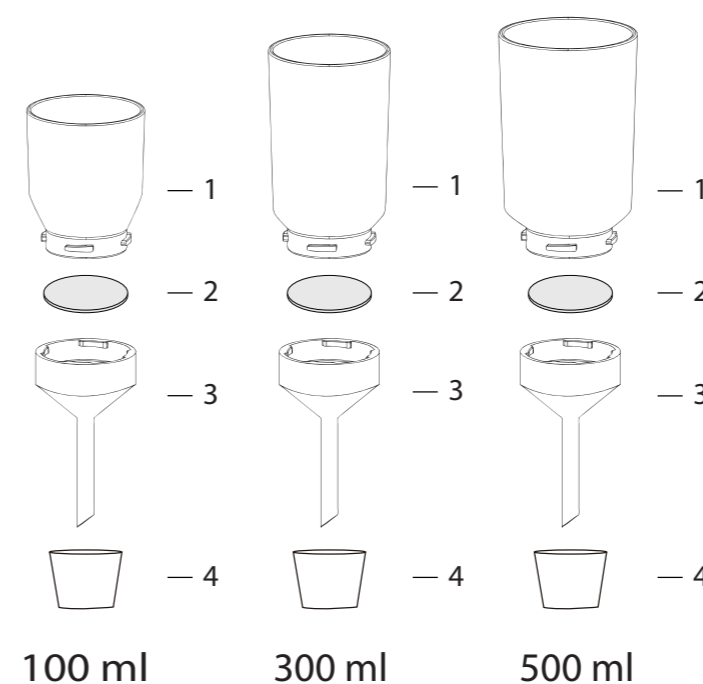

Ordering Information

SS 1, Stainless Steel Filter Holder (100 ml) 167103-10

- 1 Stainless steel funnel, 100 ml 167103-61
- 2 Stainless steel support screen 167100-31
- 3 Stainless steel support base 167103-60
- 4 Silicone stopper (No.8) 167110-16

SS 3, Stainless Steel Filter Holder (300 ml) 167103-30

- 1 Stainless steel funnel, 300 ml 167103-63
- 2 Stainless steel support screen 167100-31
- 3 Stainless steel support base 167103-60
- 4 Silicone stopper (No.8) 167110-16

SS 5, Stainless Steel Filter Holder (500 ml) 167103-50

- 1 Stainless steel funnel, 500 ml 167103-65
- 2 Stainless steel support screen 167100-31
- 3 Stainless steel support base 167103-60
- 4 Silicone stopper (No.8) 167110-16

SS, Stainless Steel Lid

- 100 ml Stainless steel lid 167103-11
- 300 ml Stainless steel lid 167103-13
- 500 ml Stainless steel lid 167103-15

47 mm PES Filtration Apparatus



LF 30



MF 31

Features

- LF 30: Spin-lock connection (M381450) and built-in overflow protection provide a fast, stable and safe operation.
- MF 31: Strong magnetic seal (I5551337) allows one-handed operation and can drain the filtrate away directly without removing tubes.

Applications

General filtration, such as microbiological test, suspended solid analysis etc.

Specifications

Material	LF 30	MF 31
Funnel	PES	PES
Support base	PC	PES
Membrane support	PP	PES
Receiver flask	PC	Borosilicate glass
Syringe filter	PTFE	PTFE
Drain hose	-	Rubber (non-autoclavable)

Specifications

	LF 30	MF 31
Funnel capacity	300 ml	300 ml
Flask capacity	1200 ml	1000 ml
Filter diameter	47 mm	47 mm
Effective filtration area	12.5 cm ²	13.1 cm ²
Hose barb	5/16 inch (8 mm)	5/16 inch (8 mm)
Syringe filter	25 mm, 0.2 μm	25 mm, 0.2 μm
Drain device	-	Yes
Overflow protection	Yes	-

Ordering Information

LF 30, 47 mm Filtration Set	197010-30
-----------------------------	-----------

1	PP lid kit	197000-36
2	PES funnel, 300 ml	197000-34
3	PC support base	197000-35
4	Black PP cap	197000-40
5	PC cover	197000-32-PC
6	Overflow protection	197000-39
7	PC bottle, 1200 ml	197000-31-PC

MF 31, 47 mm Filtration Set	200320-31
-----------------------------	-----------

1	PP lid kit for magnetic funnel	200300-36
2	PES magnetic funnel, 300ml	200300-30
3	PES magnetic support base	200300-32
4	Silicone stopper (No.8)	167110-16
5	Receiver flask with drain, 1000 ml (with screwthread connector)	167300-08
6	Silicone fixing sucker	167200-45

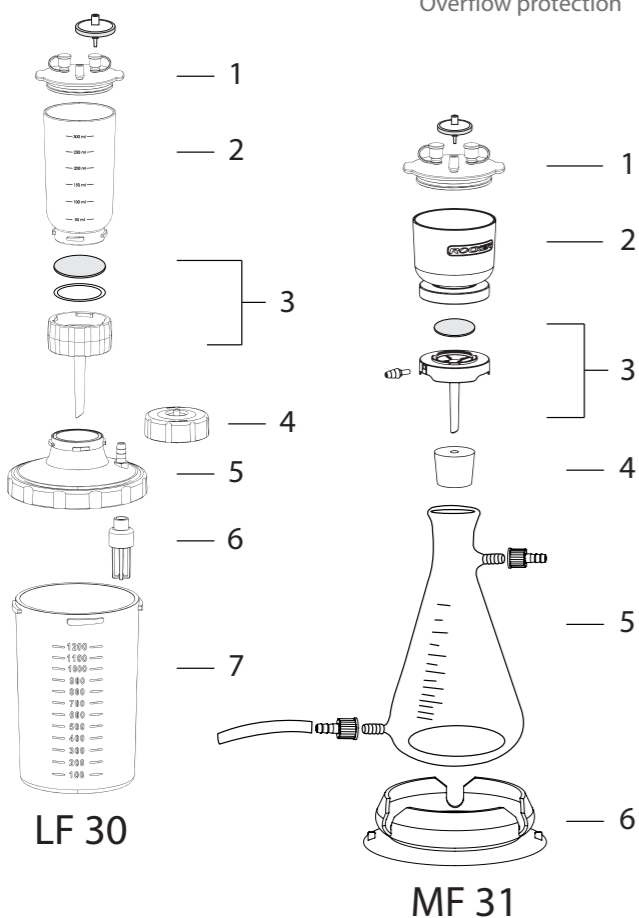

47 mm Stainless Steel Filtration Apparatus



VF 2



VF 11

Features

- Spin-lock connection (M381450) facilitates fast and stable installation without clamp.
- SS316 funnel offers excellent chemical resistance and can be fast sterilized by flame.
- Drains the filtrate away directly without removing the tubes.

Applications

Microbiological test and purification of corrosive liquid, solvent etc.

Specifications

Material	VF 2	VF 11
Funnel	SS316	SS316
Support base	SS316	SS316
Membrane support	SS316	SS316
Stopper	Silicone rubber (No.8)	Silicone rubber (No.18)
Receiver flask	Borosilicate glass	Borosilicate glass
Drain hose	Rubber (non-autoclavable)	Rubber (non-autoclavable)

Specifications

	VF 2	VF 11
Funnel capacity	100 ml	500 ml
Flask capacity	1000 ml	2000 ml
Filter diameter	47 mm	47 mm
Effective filtration area	9.6 cm ²	9.6 cm ²
Hose barb	5/16 inch (8 mm)	5/16 inch (8 mm)
Funnel graduation	50 ml / 100 ml	300 ml / 500 ml

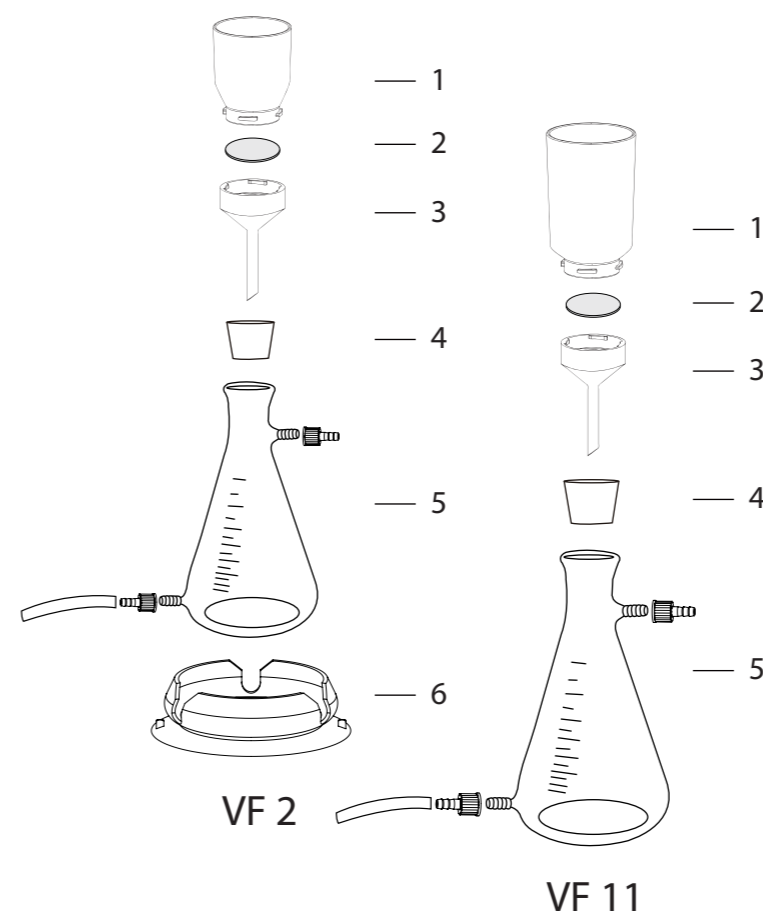

Ordering Information

VF 2, 47 mm Stainless Steel Filtration Set	167200-02
--	-----------

SS 1, Stainless Steel Filter Holder (100 ml)	167103-10
--	-----------

1	Stainless steel funnel, 100 ml	167103-61
2	Stainless steel support screen	167100-31
3	Stainless steel support base	167103-60
4	Silicone stopper (No.8)	167110-16

5	Receiver flask with drain, 1000 ml (with screwthread connector)	167300-08
6	Silicone fixing sucker	167200-45

VF 11, 47 mm Stainless Steel Filtration Set	167200-11
---	-----------

SS 5, Stainless Steel Filter Holder (500 ml)	167103-50
--	-----------

1	Stainless steel funnel, 500 ml	167103-65
2	Stainless steel support screen	167100-31
3	Stainless steel support base	167103-60
4	Silicone stopper (No.18)	167110-18

5	Receiver flask with drain, 2000 ml (with screwthread connector)	167200-13
---	---	-----------

25 mm Microanalysis Glass Filtration Apparatus



VF 5



VF 8

Features

- Clearly-marked graduations in funnel are convenient for sample addition.
- Sintered glass or stainless steel screen membrane support to meet your needs.

Applications

Small volume vacuum filtration for biological or particulate contamination analysis.

Specifications

Material	VF 5	VF 8
Funnel	Borosilicate glass	Borosilicate glass
Support base	Borosilicate glass	Borosilicate glass
Membrane support	Sintered glass	SS screen with PTFE gasket
Clamp	Aluminum	Aluminum
Stopper	Silicone rubber (No.5)	Silicone rubber (No.5)
Receiver flask	Borosilicate glass	Borosilicate glass

Specifications

	VF 5	VF 8
Funnel capacity	15 ml	15 ml
Flask capacity	125 ml	125 ml
Filter diameter	25 mm	25 mm
Effective filtration area	2.2 cm ²	2.2 cm ²
Hose barb	5/16 inch (8 mm)	5/16 inch (8 mm)

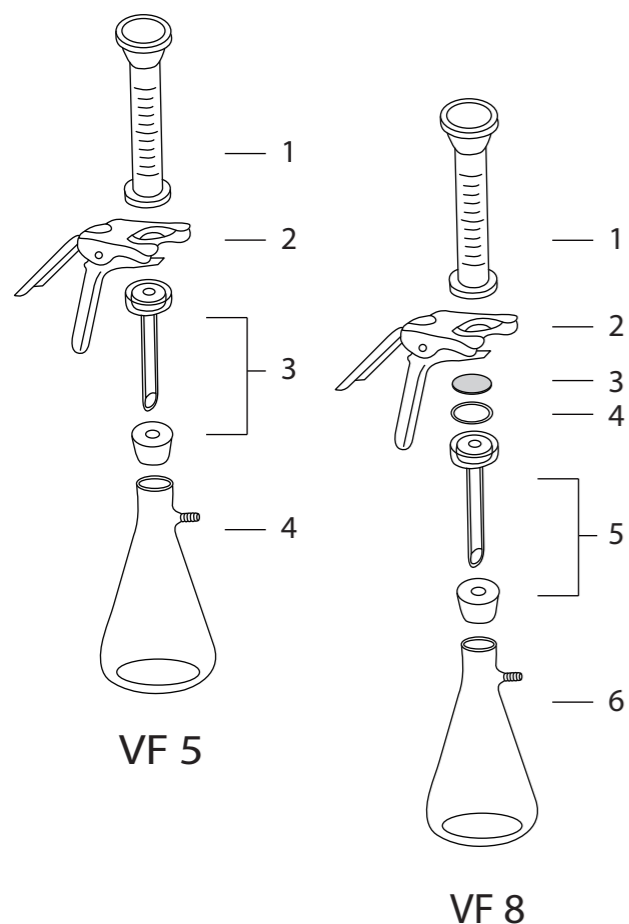

Ordering Information

VF 5, 25mm Microanalysis Glass Filtration Set 167200-05

15 ml Glass filter holder 167120-32		
1	Glass funnel, 15 ml	167220-15
2	Aluminum clamp	167240-05
3	Sintered glass support base (Including No.5 silicone stopper)	167230-04
4	Receiver flask, 125 ml	167250-05

VF 8, 25 mm Microanalysis Glass Filtration Set 167200-08

15 ml Glass filter holder 167120-34		
1	Glass funnel, 15 ml	167220-15
2	Aluminum clamp	167240-05
3	SS support screen	167230-32
4	PTFE gasket	167230-42
5	Glass support base (Including No.5 silicone stopper)	167230-08
6	Receiver flask, 125 ml	167250-05

47 mm Glass Filtration Apparatus



VF 6



VF 7

Features

- The screwthread connector helps remove the silicone tube quickly.
- The silicone fixing sucker prevents the receiver flask from tipping over accidentally.

Applications

Solvent purification and general filtration such as microbiology, suspended solid analysis etc.

Specifications

Material	VF 6	VF 7
Funnel	Borosilicate glass	Borosilicate glass
Support base	Borosilicate glass	Borosilicate glass
Membrane support	Sintered glass	SS screen with PTFE gasket
Clamp	Aluminum	Aluminum
Stopper	Silicone rubber (No.8)	Silicone rubber (No.8)
Receiver flask	Borosilicate glass	Borosilicate glass

Specifications

	VF 6	VF 7
Funnel capacity	300 ml	300 ml
Flask capacity	1000 ml	1000 ml
Filter diameter	47 mm	47 mm
Effective filtration area	9.6 cm ²	9.6 cm ²
Hose barb	5/16 inch (8 mm)	5/16 inch (8 mm)

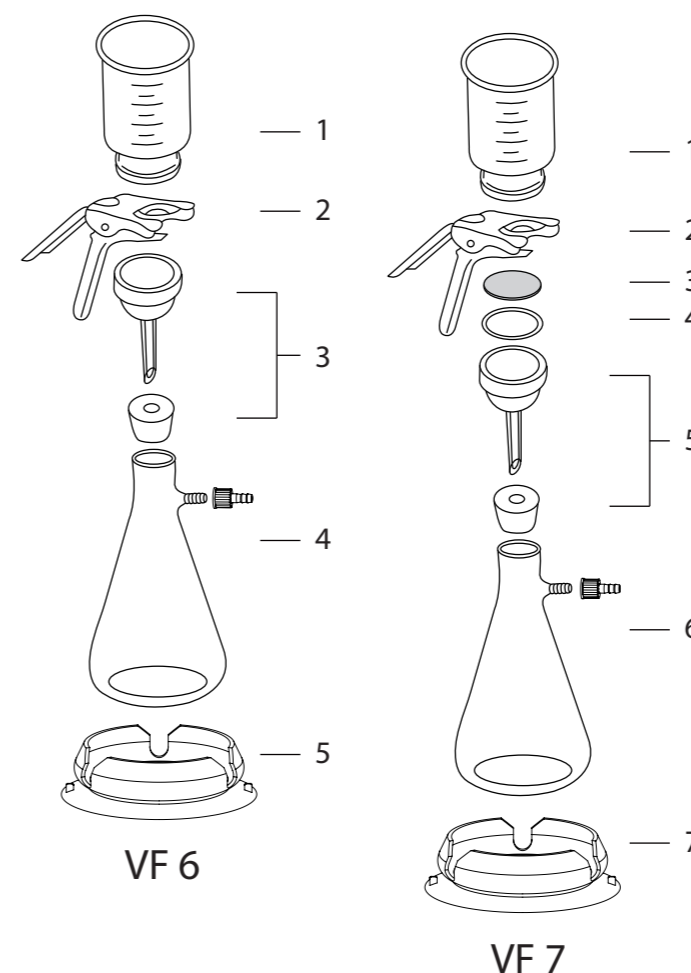

Ordering Information

VF 6, 47 mm Glass Filtration Set 167200-06

300 ml Glass filter holder 167120-31		
1	Glass funnel, 300 ml	167210-03
2	Aluminum clamp	167240-01
3	Sintered glass support base (Including No.8 silicone stopper)	167230-03
4	Receiver flask, 1000 ml (with screwthread connector)	167250-03
5	Silicone fixing sucker	167200-45

VF 7, 47 mm Glass Filtration Set 167200-07

300 ml Glass filter holder 167120-33		
1	Glass funnel, 300 ml	167210-03
2	Aluminum clamp	167240-01
3	SS support screen	167230-31
4	PTFE gasket	167230-41
5	Glass support base (Including No.8 silicone stopper)	167230-07
6	Receiver flask, 1000 ml (with screwthread connector)	167250-03
7	Silicone fixing sucker	167200-45

47 mm, 90 mm Glass Filtration Apparatus



VF 3

Features

- ◆ The screwthread connector helps remove the silicone tube quickly.
- ◆ The silicone fixing sucker prevents the receiver flask from tipping over accidentally.
- ◆ The filter holder and flask, connected by sintered glass, have better resistance of corrosive liquid.

Applications

Purification of organic, corrosive liquid such as solvent (mobile phase) for HPLC and GC analysis.

Specifications

Material	VF 3	VF 10
Funnel	Borosilicate glass	Borosilicate glass
Support base	Borosilicate glass	Borosilicate glass
Membrane support	Sintered glass	Metal coating PTFE
Clamp	Aluminum	Aluminum
Receiver flask	Borosilicate glass	Borosilicate glass

Specifications

Funnel capacity	300 ml	1000 ml
Flask capacity	1000 ml	4000 ml
Filter diameter	47 mm	90 mm
Effective filtration area	9.6 cm ²	40.6 cm ²
Hose barb	5/16 inch (8 mm)	5/16 inch (8 mm)



VF 10

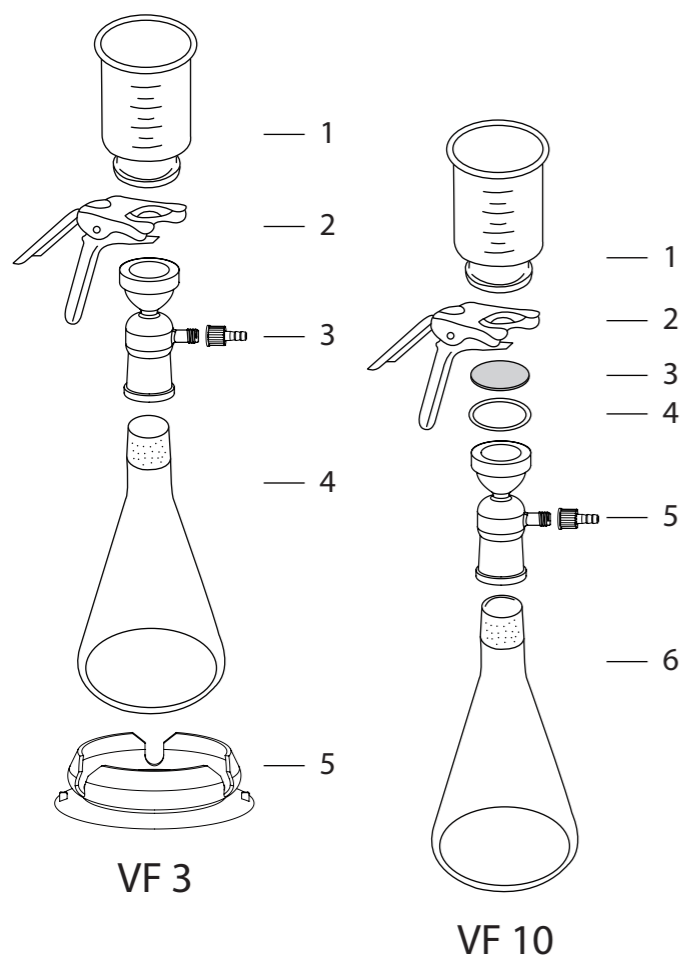

VF 3

VF 10

Ordering Information

VF 3, 47 mm Glass Filtration Set 167200-03

300 ml Glass filter holder 167120-30

1	Glass funnel, 300 ml	167210-03
2	Aluminum clamp	167240-01
3	Sintered glass support base w/ tubulated cap (with screwthread connector)	167230-01
4	Ground joint flask, 1000 ml	167250-01
5	Silicone fixing sucker	167200-45

VF 10, 90 mm Glass Filtration Set 167200-10

1000 ml Glass filter holder 167120-35

1	Glass funnel, 1000 ml	167210-10
2	Aluminum clamp	167240-02
3	PTFE coating support screen	167230-33
4	PTFE gasket	167230-43
5	Glass support base w/ tubulated cap (with screwthread connector)	167230-09
6	Ground joint flask, 4000 ml	167250-06

47 mm, 90 mm Glass Filtration Apparatus



VF 12

Features

- ◆ Unique filtration adaptor design can be connected with GL45 storage bottle.
- ◆ VF 12 / VF 15 can filtrate and store solution directly in GL45 storage bottle without the need of being transferred from the filtering flask.

Applications

Purification of organic, corrosive liquid such as solvent (mobile phase) for HPLC and GC analysis.

Specifications

Material	VF 12	VF 15
Funnel	Borosilicate glass	Borosilicate glass
Support base	Borosilicate glass	Borosilicate glass
Membrane support	Sintered glass	Metal coating PTFE
Clamp	Aluminum	Aluminum
Filtration Adaptor	PP (Autoclavable)	PP (Autoclavable)
Storage Bottle	Borosilicate glass	Borosilicate glass

Specifications

Funnel capacity	300 ml	1000ml
Flask capacity	1000 ml	5000 ml
Filter diameter	47 mm	90 mm
Effective filtration area	9.6 cm ²	40.6 cm ²
Hose barb	5/16 inch (8 mm)	5/16 inch (8 mm)



VF 15

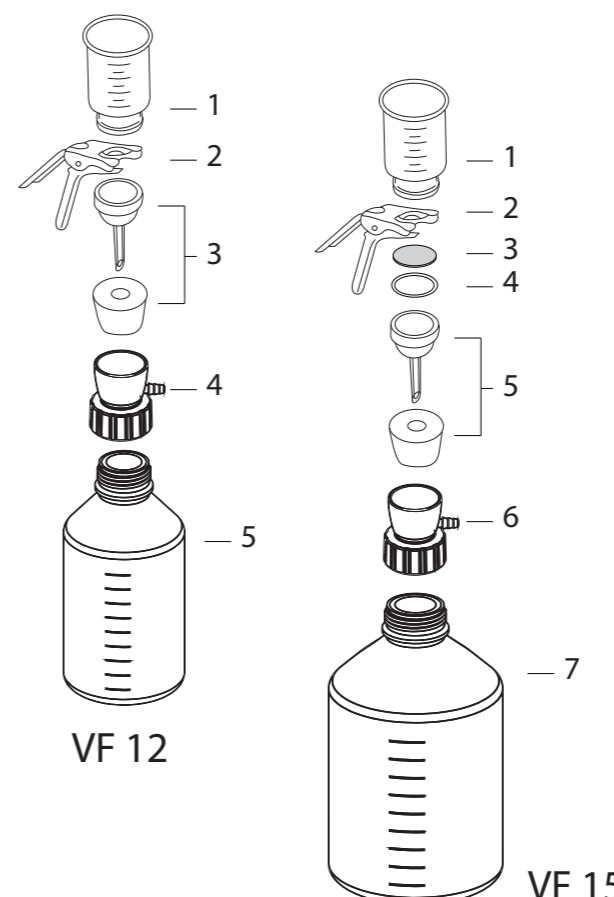

VF 12

VF 15

Ordering Information

VF 12, 47 mm Glass Filtration Set 167200-12

300 ml Glass filter holder 167120-31

1	Glass funnel, 300 ml	167210-03
2	Aluminum clamp	167240-01
3	Sintered glass support base (Including No.8 silicone stopper)	167230-03
4	Filtration Adaptor for GL45 Bottle	197000-65
5	1000ml laboratory glass bottle	197000-59

VF 15, 90 mm Glass Filtration Set 167200-15

1000 ml Glass filter holder 167120-37

1	Glass funnel, 1000 ml	167210-10
2	Aluminum clamp	167240-02
3	PTFE coating support screen	167230-33
4	PTFE gasket	167230-43
5	Glass support base (Including No.8 silicone stopper)	167230-10
6	Filtration Adaptor for GL45 Bottle	197000-65
7	5000ml laboratory glass bottle	197000-55